

KEYED NOTES

- A. HORIZONTAL CHANNEL SLOPE:
- B. BOTTOM OF CHANNEL WIDTH:
- C. PIPE DIAMETER:
- D. ROADWAY WIDTH:
- E. CHANNEL DEPTH:
- F. UPSTREAM CHANNEL INVERT ELV.:
- G. DOWNSTREAM CHANNEL INVERT ELV.:
- H. PIPE TOTAL LENGTH:

FOR INFORMATIONAL USE ONLY

MIDDLE RIO GRANDE CONSERVANCY DISTRICT	STRAIGHT HEADWALL CROSSING (1/2)
LICENSE NO. _____	DITCH & STA. _____
MIDDLE RIO GRANDE CONSERVANCY DISTRICT	

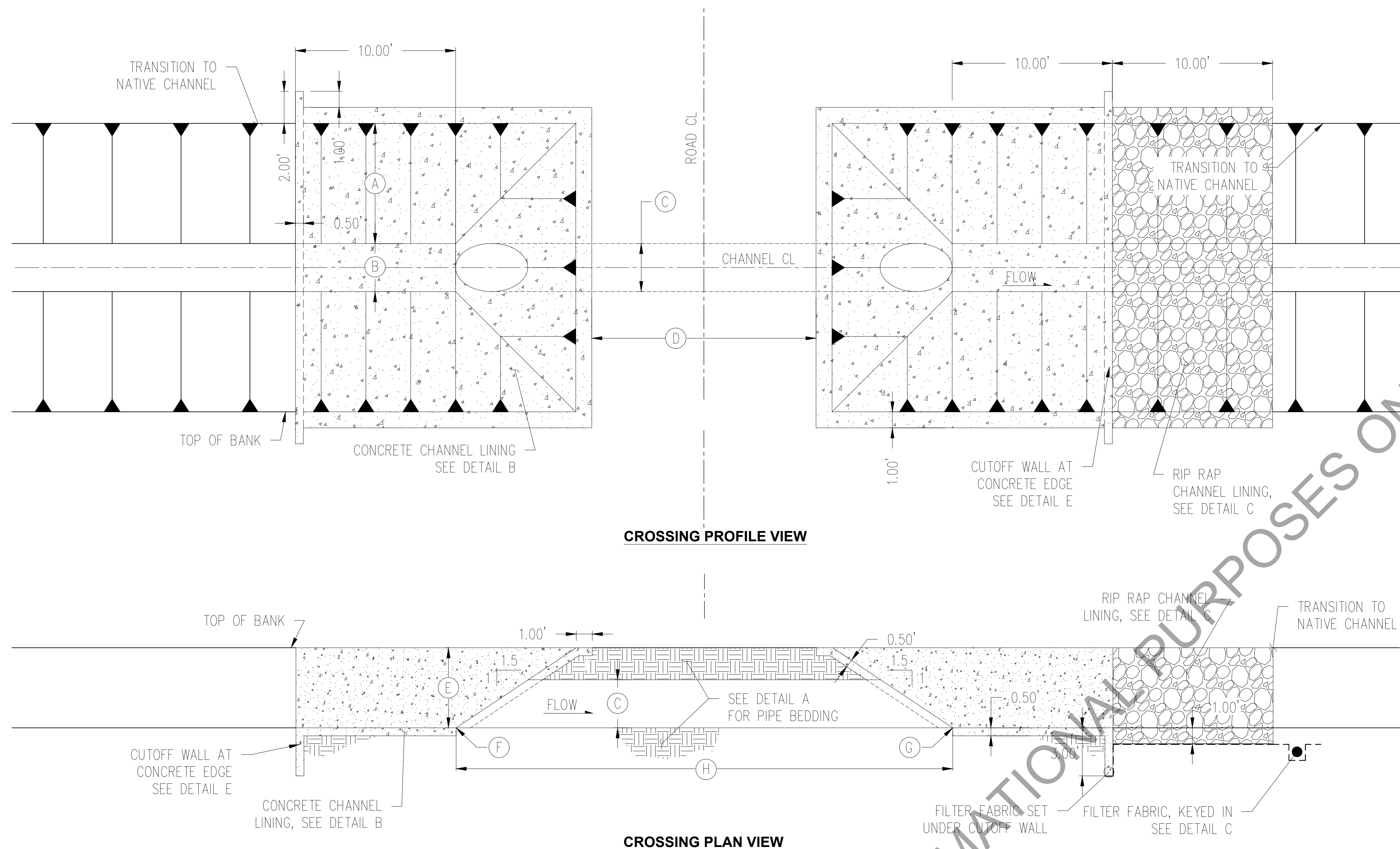

KEYED NOTES

- A. HORIZONTAL CHANNEL SLOPE:
- B. BOTTOM OF CHANNEL WIDTH:
- C. PIPE DIAMETER:
- D. ROADWAY WIDTH:
- E. CHANNEL DEPTH:
- F. UPSTREAM CHANNEL INVERT ELV.:
- G. DOWNSTREAM CHANNEL INVERT ELV.:
- H. PIPE TOTAL LENGTH:

FOR INFORMATIONAL PURPOSES ONLY

MIDDLE RIO GRANDE CONSERVANCY DISTRICT

SLOPED CULVERT CROSSING (1/2)

LICENSE NO. _____
DITCH & STA. _____

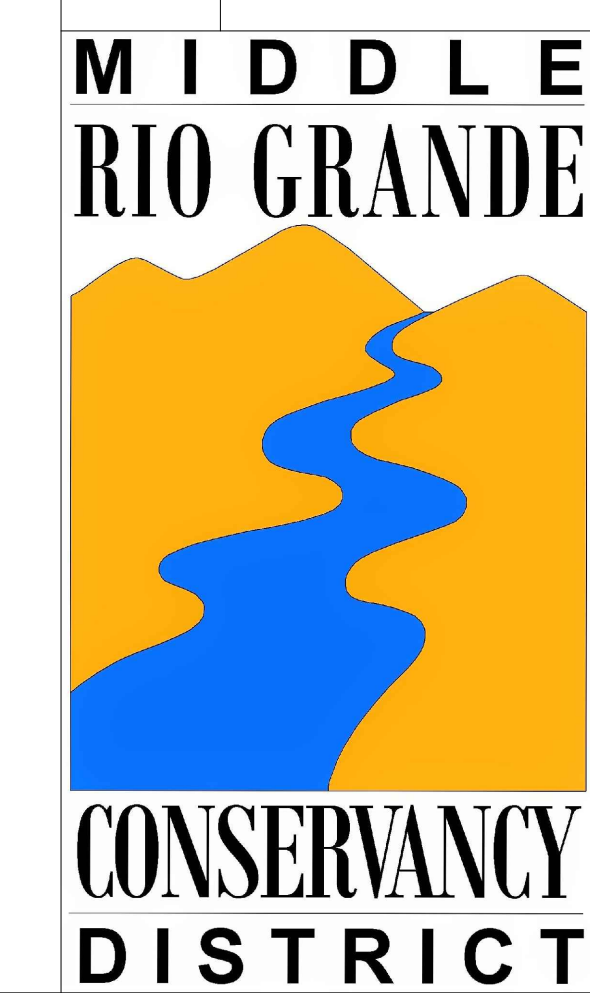

GENERAL NOTES:

1. FOR NEW TO EXISTING CONCRETE CONNECTIONS, THE ENGINEERING DEPARTMENT SHALL BE NOTIFIED TO INSPECT THE EXISTING CONCRETE AND STEEL REINFORCEMENT TO DETERMINE THE USE OF ONE OF THE FOLLOWING OPTIONS:

OPTION 1: THE EXISTING CHANNEL LINING SHALL BE SAWCUT AS FAR BACK AS NECESSARY (2.5' MINIMUM) UNTIL A CLEAN AND STABLE END SECTION CAN BE ACHIEVED. THE NEW CHANNEL LINING CAN THEN BE CONSTRUCTED AND TIED TO THE EXISTING CONCRETE.

OPTION 2: IF IT IS NOT FEASIBLE TO TIE INTO THE EXISTING CHANNEL LINING, A CUTOFF WALL SHALL BE CONSTRUCTED AT THE END OF THE CONCRETE SECTION, ABUTTING THE EXISTING CONCRETE.

2. APPLY UNLESS NOTED ON DRAWINGS. IN CASE OF CONFLICT BETWEEN GSN, DETAILS AND PLANS, THE GREATER REQUIREMENTS GOVERN.

3. THE CONTRACTOR SHALL REFER TO STANDARD SECTION 206 OF THE NMDOT STANDARD SPECIFICATIONS FOR HIGHWAY AND BRIDGE CONSTRUCTION - 2019 EDITION.

CHANNEL CONSTRUCTION

CAST-IN-PLACE CONCRETE: CONCRETE SHALL BE IN ACCORDANCE WITH PROJECT SPECIFICATIONS. ($f_c = 3000$ psi MINIMUM). $\frac{3}{8}$ " CHAMFER ON ALL EXPOSED FORMED EDGES UNLESS OTHERWISE NOTED.

REINFORCING STEEL: STEEL REINFORCEMENT AND PLACEMENT SHALL BE IN ACCORDANCE WITH PROJECT SPECIFICATIONS AND SHALL CONFORM TO ASTM A615, GRADE 60. ALL LAP SPLICES SHALL BE CLASS "B" UNLESS OTHERWISE NOTED.

CONTROL JOINTS SHALL BE NO MORE THAN 12' APART.

INSTALLATION OF CORRUGATED METAL PIPES SHOULD CONFORM TO THE NCSIPA INSTALLATION MANUAL FOR CORRUGATED STEEL PIPE AND STRUCTURAL PLATE UNLESS OTHERWISE NOTED.

TEMPORARY INSTALLATIONS SHALL BE REMOVED OR REPLACED BY THE BEGINNING OF THE NEXT IRRIGATION SEASON.

KEYED NOTES:

1. EUCO ARC LITHIUM NITRATE COATING OR APPROVED EQUAL APPLIED TO VERTICAL SURFACE AND 12" OF TOP SURFACE OF EXISTING CONCRETE TO REMAIN.

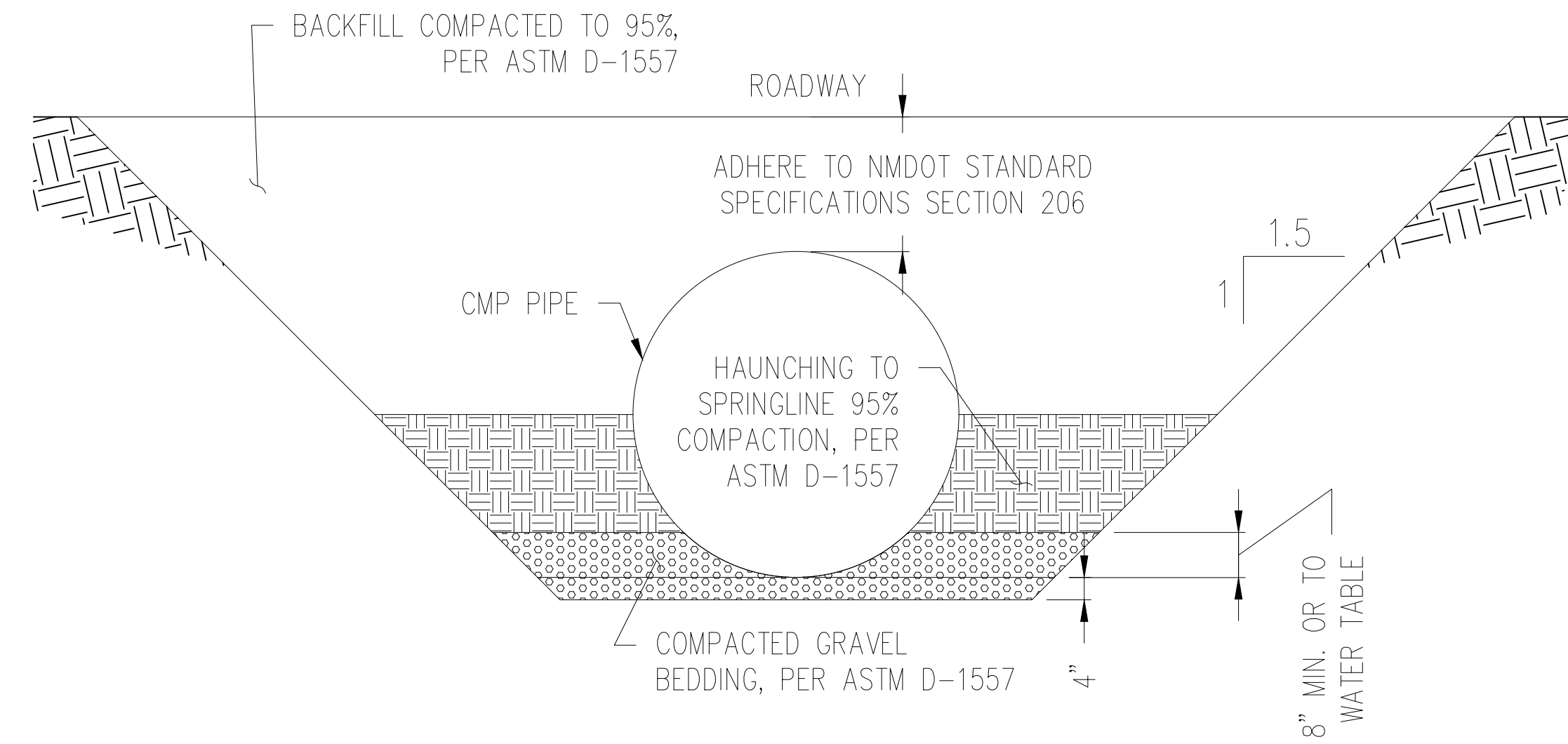

DETAIL A: PIPE BEDDING DETAIL

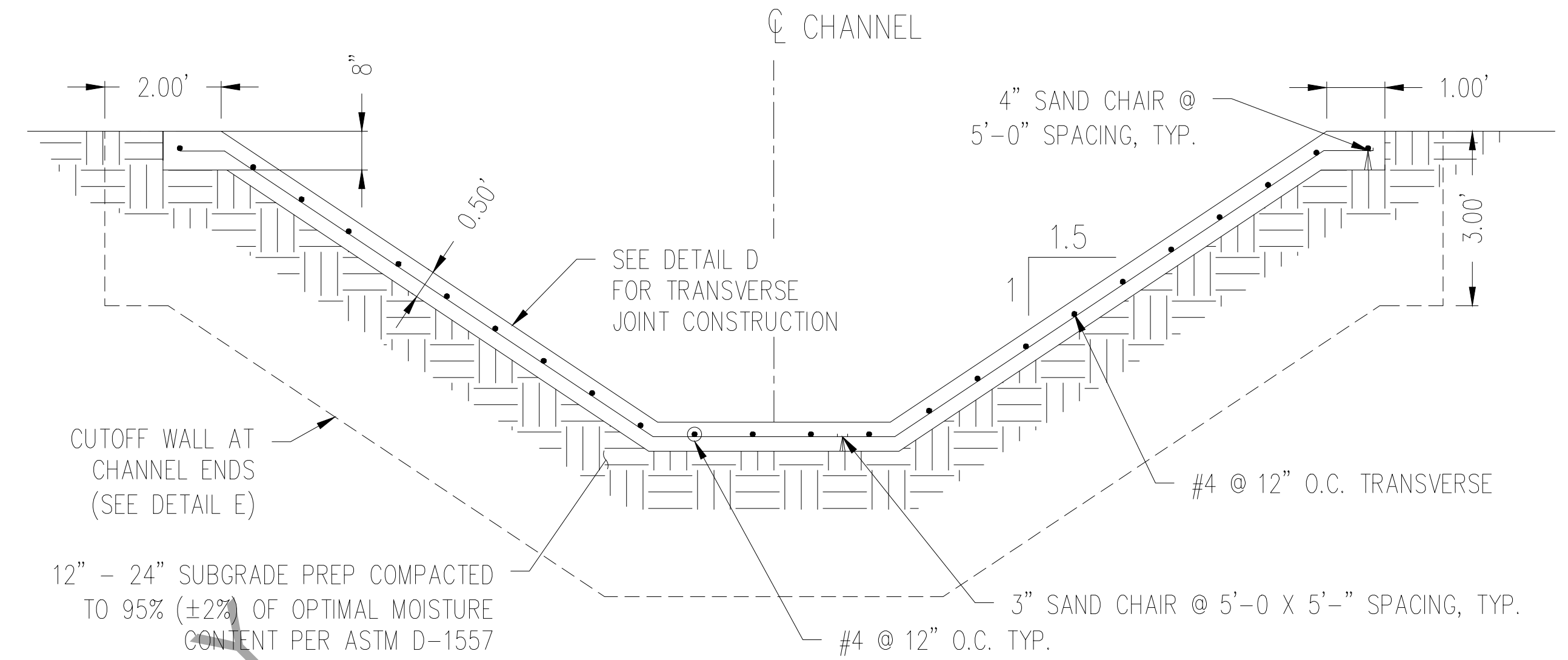

DETAIL B: CONCRETE CHANNEL LINING

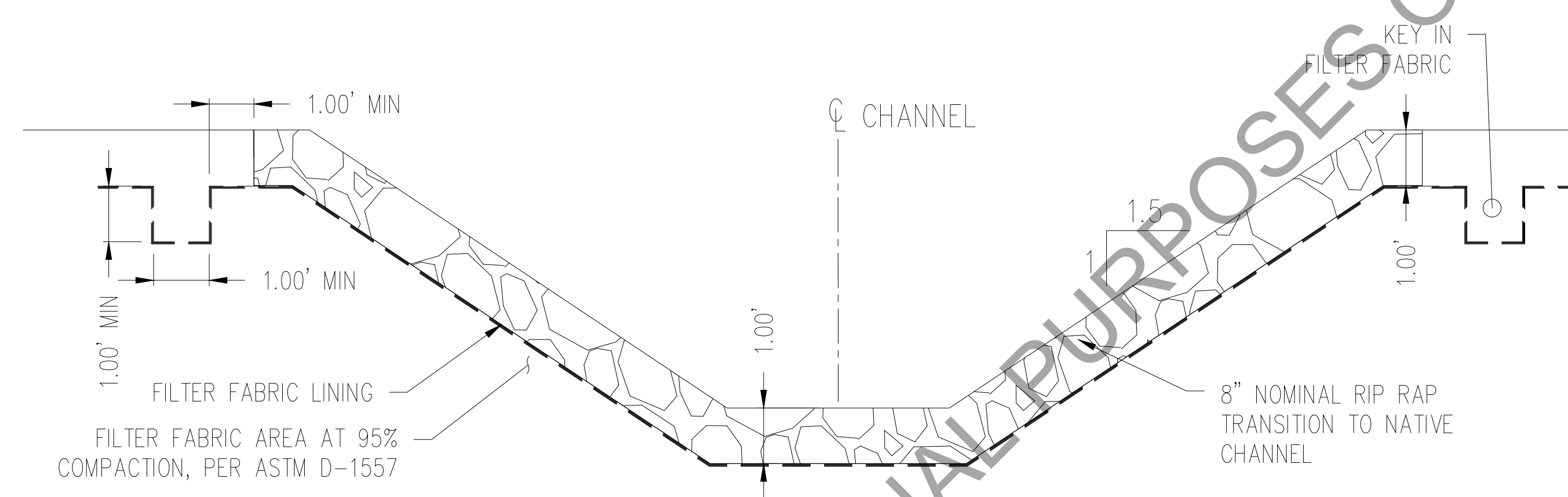

DETAIL C: RIP RAP LINING

NOTE: CONTROL JOINTS SHALL BE NO MORE THAN 12' APART

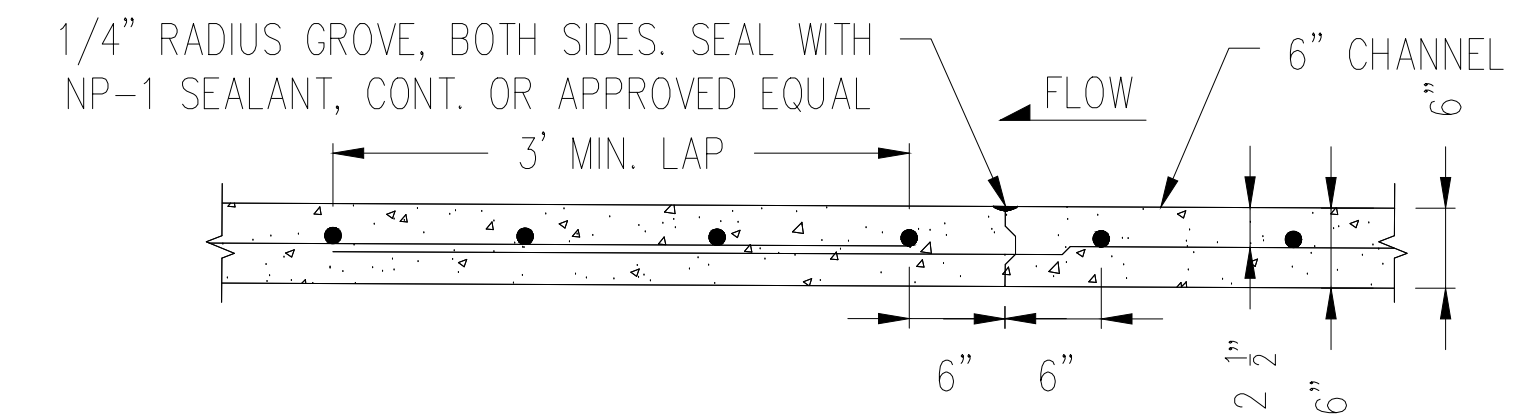

DETAIL D: TYPICAL TRANSVERSE CONSTRUCTION JOINT

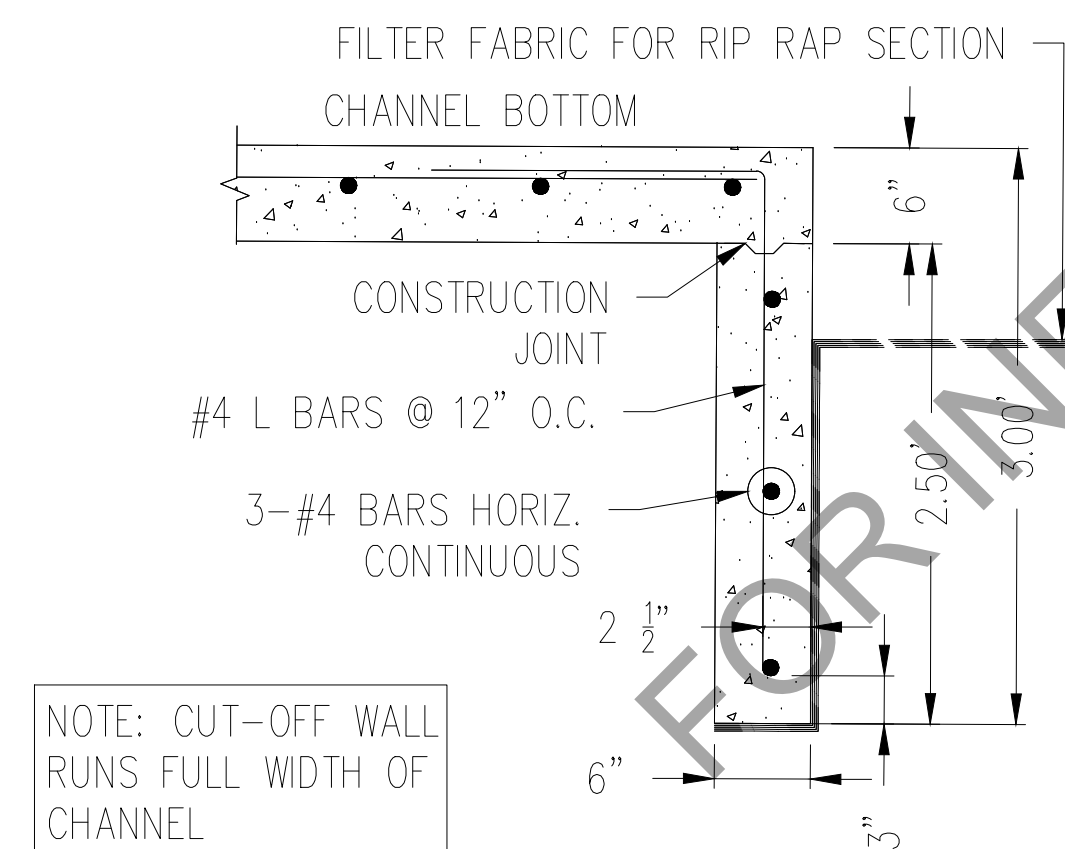

DETAIL E: TYPICAL CUTOFF WALL SECTION

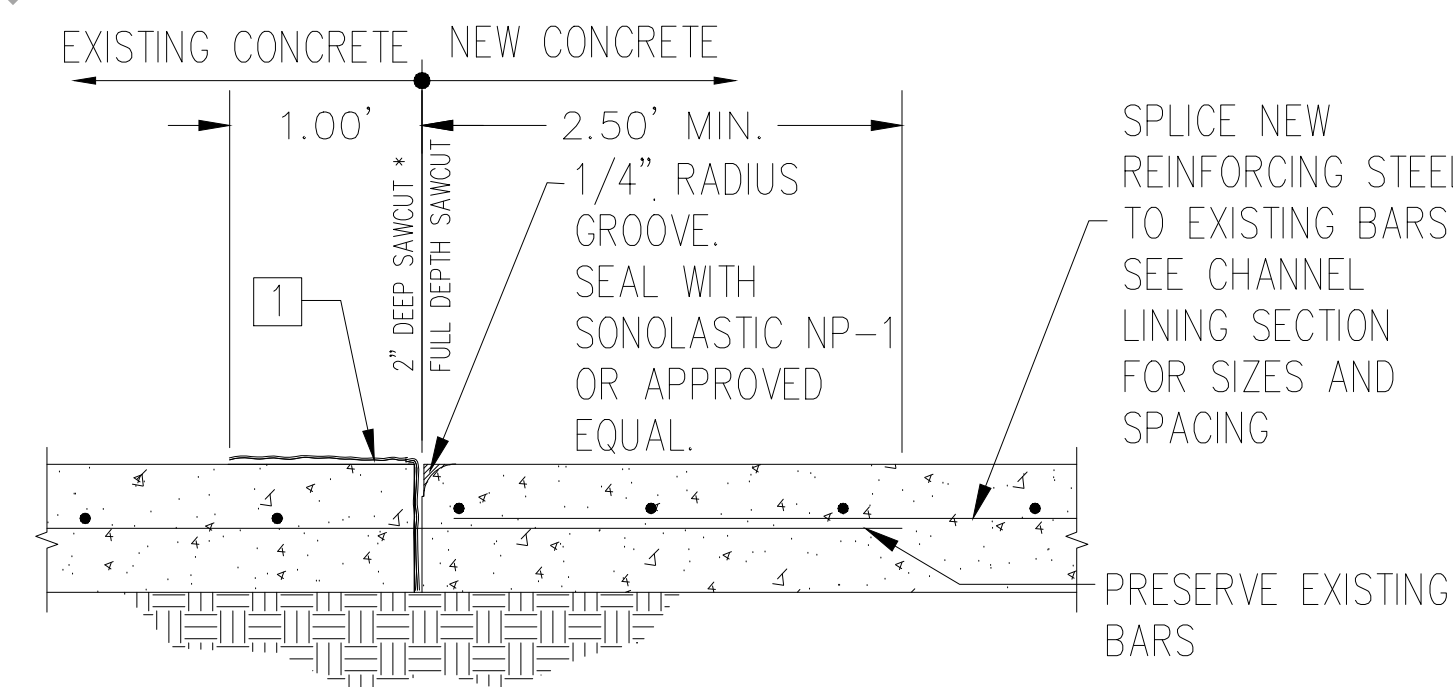

OPTION 1: NEW TO EXISTING CHANNEL LINING CONSTRUCTION ANCHORING

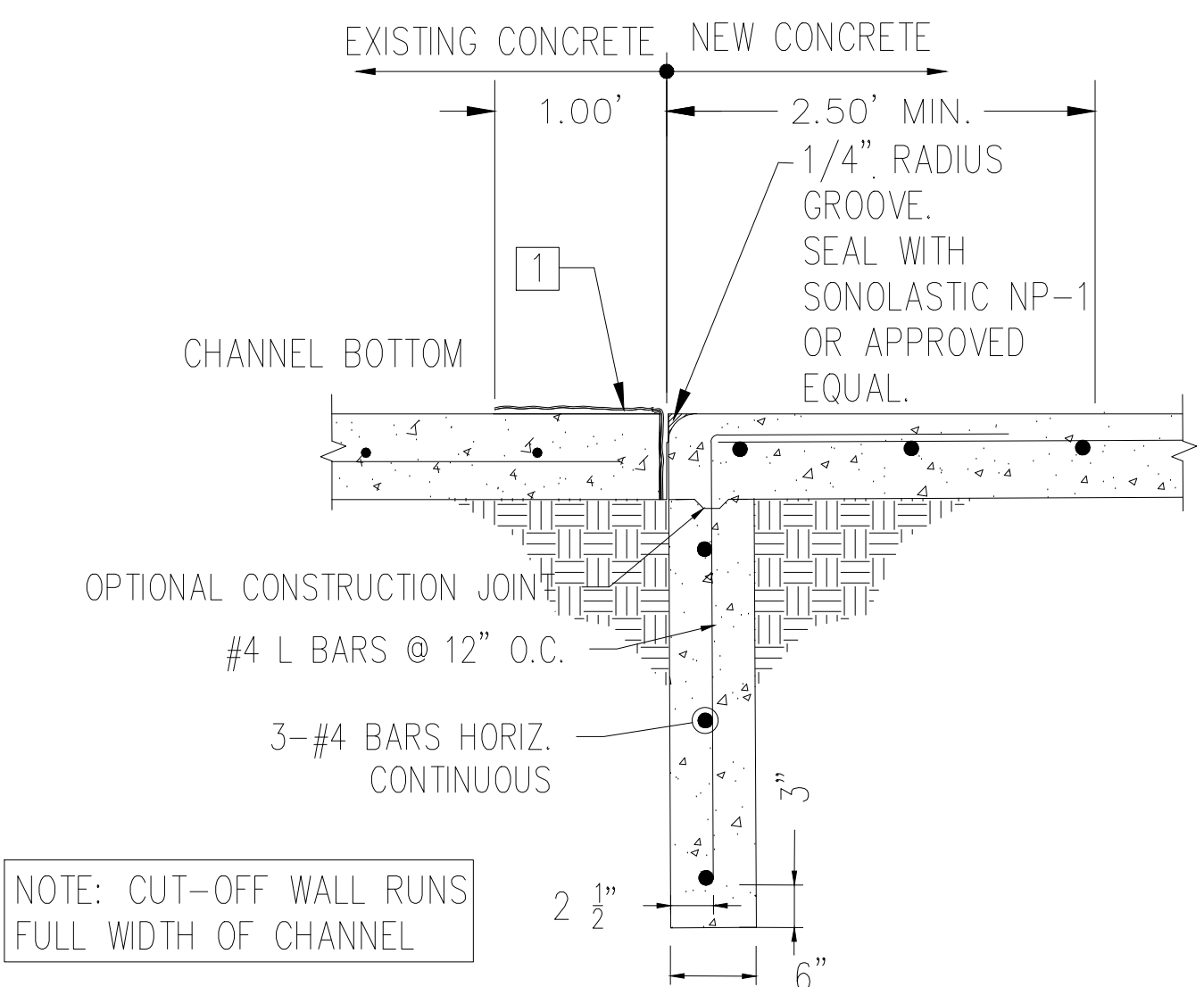

OPTION 2: NEW TO EXISTING CHANNEL LINING CUTOFF WALL

MIDDLE RIO GRANDE CONSERVANCY DISTRICT

DETAILS SHEET (2/2)

LICENSE NO. _____
DITCH & STA. _____

MIDDLE RIO GRANDE



CONSERVANCY DISTRICT